

Bergen Industries

Precision Molds for the Concrete Block and Hardscaping Industry
 Made & Engineered in America from American Steel
 800-722-0920

PATHFINDER

Sales@PathfinderSystem.com | 616-395-8447

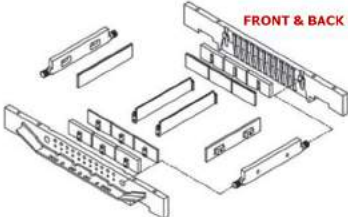
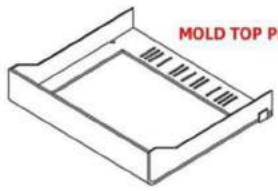
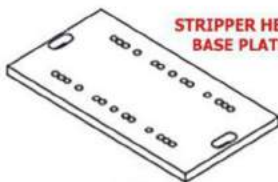
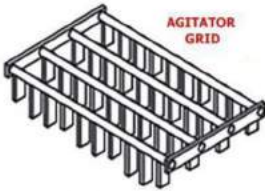

MOLDS & MOLD PARTS IN STOCK & READY TO DELIVER

FRAME COMPONENTS	STANDARD 3AAT MOLDS			6AAT MOLDS
	(6) 3-5/8" UNITS	(3) 7-5/8" UNITS	(2) 11-5/8" UNITS	(6) 7-5/8" UNITS
FRONT BACK BARS (MOLD SIDE BARS) 	2413J	2415P	2414J	39336
MOLD TOP PLATES 	2365A	2358	2359	40786
STRIPPER HEAD BASE PLATES 	1313H CALL FOR AVAILABILITY	1313A	1313B	12737YX CALL FOR AVAILABILITY
AGITATOR GRIDS, 0.50" ROUND PRONGS 	1057F	1059F	1058D	48144

STANDARD RELINE PARTS

OUTSIDE DIVISION PLATES (MOLD SIDE BARS)
1.25" THICK x 9.25" HIGH 15-5/8" LENGTH



1523YA (1523RJ - 6AAT)

INSIDE DIVISION PLATES, 0.50" THICK x 9.25"
HIGH x 15-5/8" LENGTH

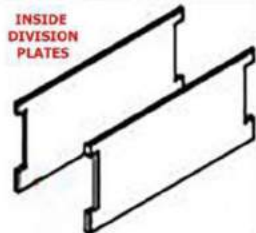

18353E - DIVISION PLATE WITH TAPPED LUG

INSIDE DIVISION PLATES, 0.50" THICK x 9.25"
HIGH x 15-5/8" LENGTH



1534YJ - DIVISION PLATE WITH EXTENDED LUG

	3-5/8" UNITS	7-5/8" UNITS	11-5/8" UNITS
--	---------------------	---------------------	----------------------

PLAIN END LINERS, 8.25" HIGH

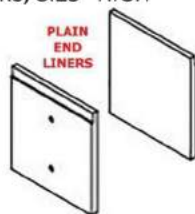

1559

1564

1566

SASH END LINER, 8.25" HIGH, 0.75" x 0.75" SASH

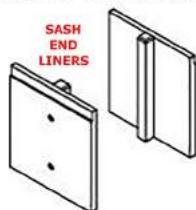

N/A

1583

1587 (LH OR RH)

END CORE LINER, 8.25" HIGH, 0.75" WIDE MORTAR
LOCK

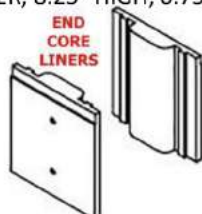

N/A

8124

8149

CHIPPING HAMMERS AND CHISELS

12675	PNEUMATIC CHIPPING HAMMER W/ 1.5" x 8" FLAT CHISEL	
TYPE	PART #	DIMENSIONS (W x L)
FLAT CHISELS	8632Z C	0.75" x 7.5"
	8632 Z	0.75" x 12"
	8632 A	0.75" x 18"
	8632Z H	1.5" x 8"
	8632 Y	2" x 8"
	8632 YK	3" x 8"
	8632 YL	3" x 12"
SPOON CHISELS	8632 ZE	7.25"
	8632 B	12"
	8632 Y	18"

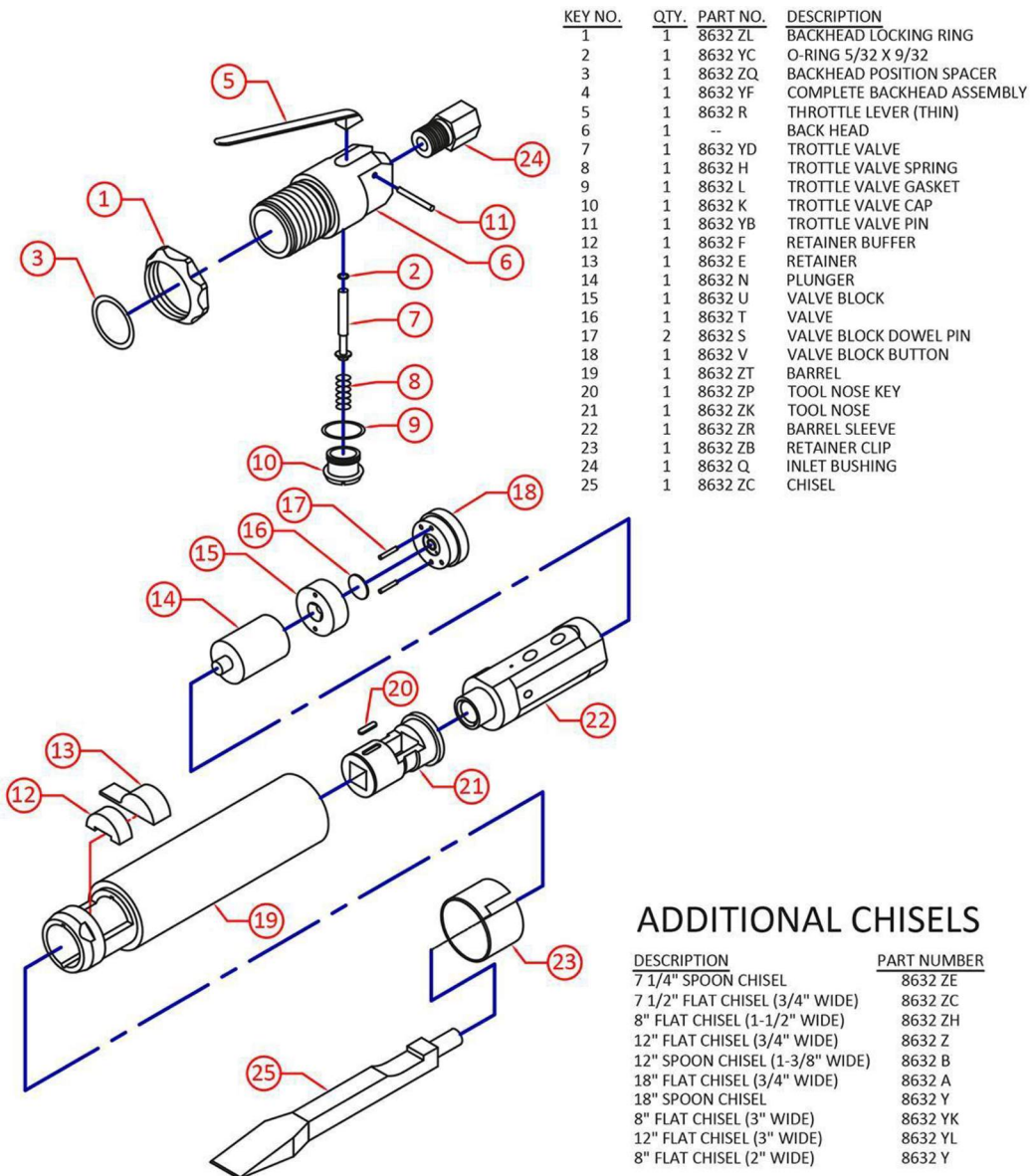

ADDITIONAL CHISELS

DESCRIPTION	PART NUMBER
7 1/4" SPOON CHISEL	8632 ZE
7 1/2" FLAT CHISEL (3/4" WIDE)	8632 ZC
8" FLAT CHISEL (1-1/2" WIDE)	8632 ZH
8" FLAT CHISEL (1-1/2" WIDE)	8632 ZH
12" FLAT CHISEL (3/4" WIDE)	8632 Z
12" SPOON CHISEL (1-3/8" WIDE)	8632 B
18" FLAT CHISEL (3/4" WIDE)	8632 A
18" SPOON CHISEL	8632 Y
8" FLAT CHISEL (3" WIDE)	8632 YK
12" FLAT CHISEL (3" WIDE)	8632 YL
8" FLAT CHISEL (2" WIDE)	8632 Y